



INSTRUCTION BULLETIN

No. 9015113
Machine: M17
Published: 02-2017
Rev. 00

NOTE: DO NOT DISCARD the Parts List from the Instruction Bulletin. Place the Parts List in the appropriate place in the machine manual for future reference. Retaining the Parts List will make it easier to reorder individual parts and will save the cost of ordering an entire kit.

NOTE: Numbers in parenthesis () are reference numbers for parts listed in Bill of Materials.

Installation instructions for **kit number 9015054**

SYNOPSIS:

This kit contains the parts needed to replace the lift channel assembly on M17 sweeper scrubber equipped with the optional scrubbing side brush assembly.
Please follow step-by-step instructions.

SPECIAL TOOLS / CONSIDERATIONS: NONE

(Estimated time to complete: 30 minutes)

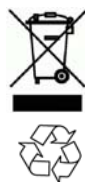

PROTECT THE ENVIRONMENT

Please dispose of packaging materials, used machine components such as batteries and fluids in an environmentally safe way according to local waste disposal regulations.

Always remember to recycle.

PREPARATION:

1. Remove the brush from the scrubbing side brush assembly. Set the brush aside.
2. Turn the machine on, place the machine into manual mode (if necessary), completely lower the scrubbing side brush assembly. Turn off the machine, set the parking brake, and remove the key.

FOR SAFETY: Before leaving or servicing machine, stop on level surface, turn off machine, set parking brake, and remove key.

INSTALLATION:

1. Remove the M8 lock hex nut and flat washer from the M8 hex screw securing the pivot pin to the scrub deck bracket and link channel. Set the flat washer aside. (Fig. 1)
2. Thread the M8 lock hex nut back onto the M8 hex screw so the M8 hex screw and M8 lock hex nut can be used to pull the pivot pin from the scrub deck bracket and link channel. (Fig. 1)

3. Pull the M8 hex screw from previous step and the pivot pin out from the scrub deck bracket and link channel. Set the M8 hex screw, flat washer, pivot pin, and M8 lock hex nut aside. (Fig. 1)
4. Remove the cotter pin and clevis pin securing the rotation clevis to the spring assembly. Set the cotter pin and clevis pin aside. (Fig. 1)
5. Remove the rotation clevis from the link channel. Set the rotation clevis, M6 hex screw, and flat washer aside. Discard the sleeve bushing. (Fig. 1)
6. Remove the M8 lock hex nut from the M8 hex screw securing the pivot pin to the arm pivot and link channel. Set the M8 lock hex nut aside. (Fig. 1)
7. Pull the M8 hex screw from the pivot pin, arm pivot and link channel. Set the M8 hex screw, both flat washers, and pivot pin aside. Discard the link channel. (Fig. 1)

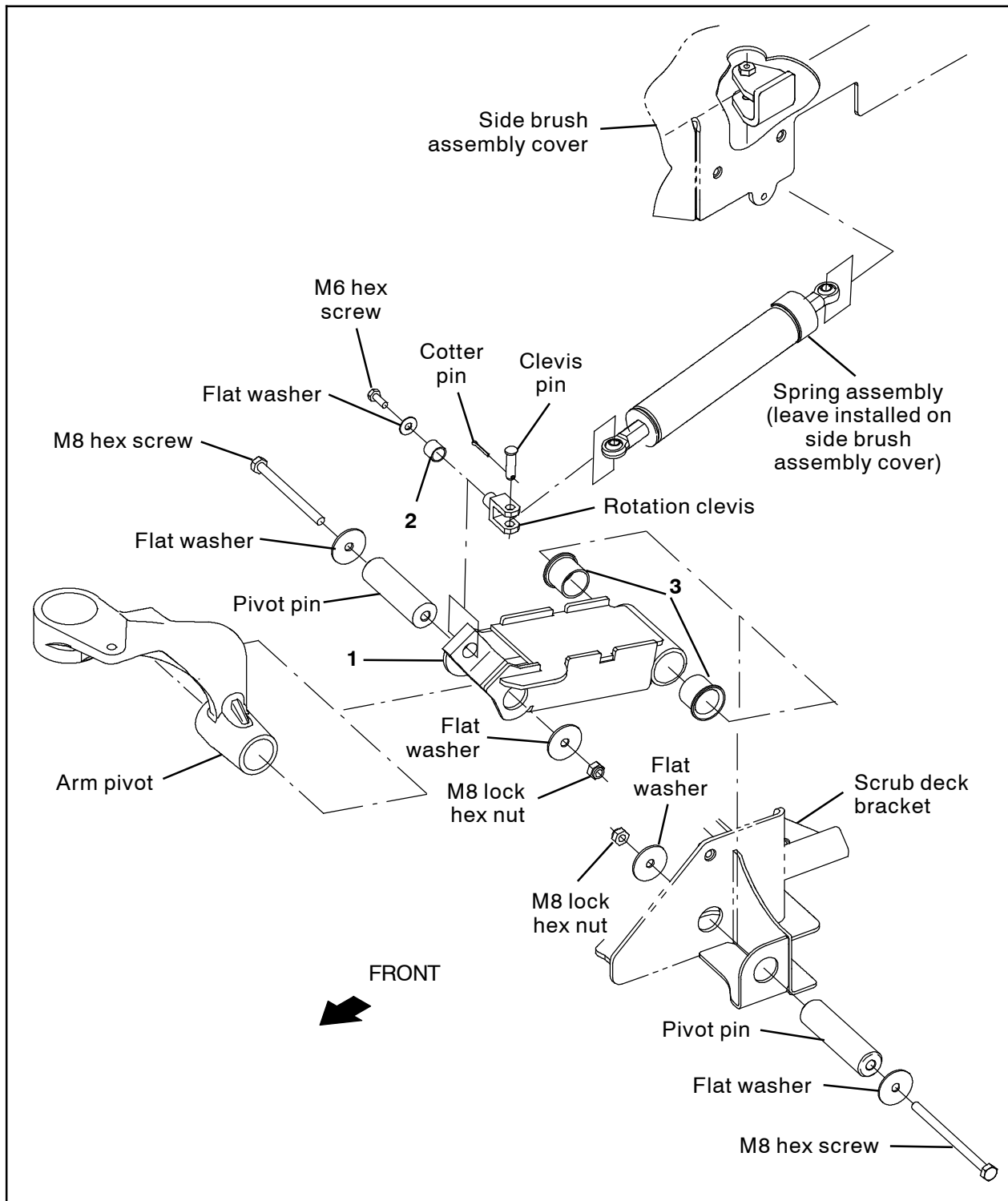

FIG. 1

8. Use the M8 hex screw, both flat washers, pivot pin, and M8 lock hex nut to install the link channel (1) onto the arm pivot. (Fig. 1)
9. Use the M6 hex screw and flat washer to install the rotation clevis onto the link channel (1). (Fig. 1)
10. Use the clevis pin and cotter pin to reinstall the rotation clevis onto the spring assembly. (Fig. 1)
11. Use the M8 hex screw, both flat washers, pivot pin, and M8 lock hex nut to install the link channel (1) onto the scrub deck bracket. (Fig. 1)

12. Turn on the machine and completely raise the scrubbing side brush assembly.
13. Reinstall the brush onto the scrubbing side brush assembly.

14. Start and test the machine. The scrubbing side brush assembly should move smoothly up and down in the full range of motion.

Bill Of Materials For Channel Assy, Lift, SBA, Afmkt [M17] - 9015054

Ref.	Tennant Part No.	Description	Qty.
1	1216256	Channel Wldt, Link	1
2	63233	Bushing, Sleeve, 0.50b 0.59d 0.50l, Brz	1
3	54618	Bushing, Flng, 1.00b 1.13d 1.00l	2

TENNANT COMPANY
P. O. Box 1452
Minneapolis, MN 55440-1452